

Composite dry sliding bushings, metric dimensions

| Principal dimensions |    |    | Basic load ratings |              | Mass   | Designation  |
|----------------------|----|----|--------------------|--------------|--------|--------------|
| d                    | D  | B  | dynamic<br>C       | static<br>C0 |        |              |
| mm                   |    |    | kN                 |              | kg     | -            |
| <b>8</b>             | 10 | 12 | 7,65               | 24           | 0,0025 | PCM 081012 E |

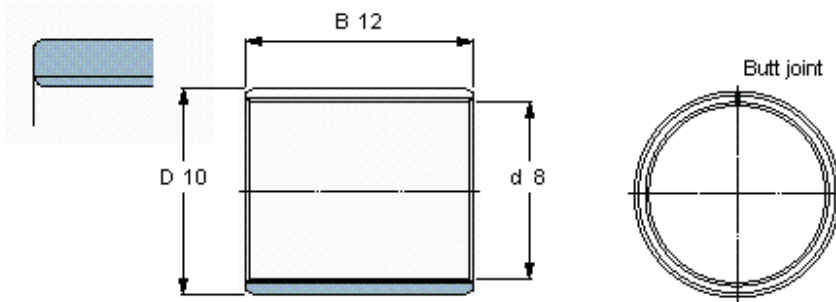

**Specific load factor** K 80  
**Material constant**  $K_M$  480